



# 600W MODULE SPORTGROUND DALI SERIES 415V (3 PHASE)

5050 LUMILED SERIES

BMP-5STAD25-600-150V-10D4



SPECIFICATIONS	
System Power	600w
Milliamps	1540Ma (368V x 2pcs)
LED type	LUMILED 5050 96Pcs each Module
Lamp Body Material	Powdercoated Galvanised Steel
Colour Temperature	4000k(3000k,5700kopt)
Luminous Flux	88,200 Lumens
Luminous Efficacy	147 Lm/w
CRI	Ra80 (Ra70/90 optional)
Beam Angle	25X25, 40X40, 60X60
Rated Lifespan	>100,000 hours Modules
IP Rating	IP67 Housing , IP68 Modules
Impact rating	IK09
Driver Type	Inventronics Flicker Free ESM-320S105DG x 2pcs
Operating Temperature	-40°C ~ 50°C
Dimmable	PWM Dimming
Test Reports	ISMT,LCP, TM21, LM80, L70
Lamp Dimension	705 x 645 x 220 mm
Net Weight	19.3kg + 3.5kg drivers
Warranty	5 years drivers, 10 years Modules
Certification	JAS/ANZ TUV

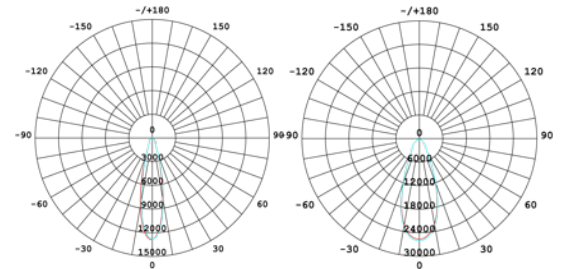
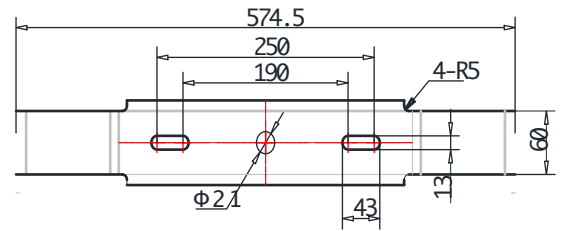
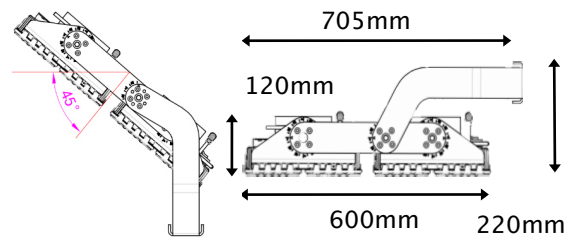

25x25 B/Angle **BMP-5STAD25-600-1504-10D4**  
40x40 B/Angle **BMP-5STAD40-600-1504-10D4**

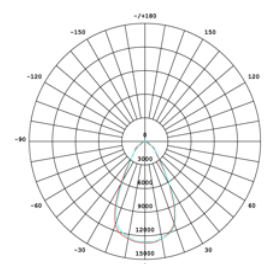

60x60 B/Angle **BMP-5STAD60-600-15054-10D4**



# 600W MODULE SPORTGROUND DALI SERIES 415V (3 PHASE)

5050 LUMILED SERIES

BMP-5STAD25-600-150V-10D4

For accessories, contact BMP LED via  
[www.bmpled.com.au/contact](http://www.bmpled.com.au/contact)

## ACCESSORIES



Light Shields  
BMP-FL40SHIELD-10



Red Laser pointer  
BMP-REDLPOINT-10



Driver Extension Cable  
2.0m,5.0m,12.0 lengths  
BMP-DEC/2/5/12-10

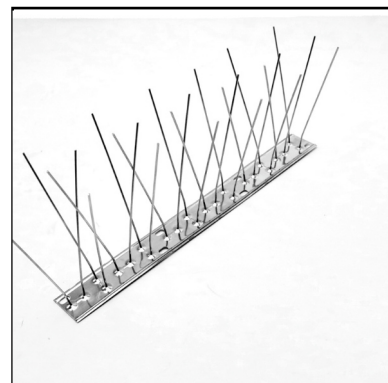

Birdspikes  
0.33m  
BMP-BIRDSPIKES-10