

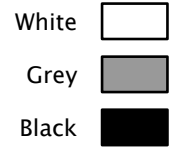

# 1000W MODULE SPORTGROUND DALI SERIES 415V (3 PHASE)

3535 LUXEON SERIES

BMP-STADLV-1000-150V-10D4



## SPECIFICATIONS

System Power	1000w
Milliamps	3240Ma
LED type	LUXEON 3535 96Pcs each Module
Lamp Body Material	Powdercoated Galvanised Steel
Colour Temperature	4000k(3000k,5700kopt)
Luminous Flux	133,050 Lumens
Luminous Efficacy	103 Lm/w
CRI	Ra80 (Ra70/90 optional)
Beam Angle	114X17, 45X12, 12X12 Horizontal
Rated Lifespan	> 100,000 hours Modules
IP Rating	IP67 Housing , IP68 Modules
Impact rating	IK09
Driver Type	Inventronics Flicker Free ESM-240S105DG x4pcs
Operating Temperature	-40°C ~ 50°C
Dimmable	PWM Dimming
Test Reports	ISMT,LCP, TM21, LM80, L70
Lamp Dimension	705 x 645 x 220 mm
Net Weight	19.3kg + 4.6kg drivers
Warranty	5 years drivers, 10 years Modules
Certification	JAS/ANZ TUV

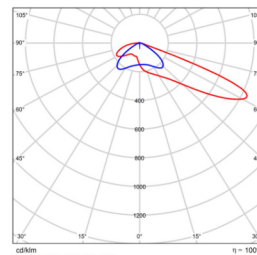
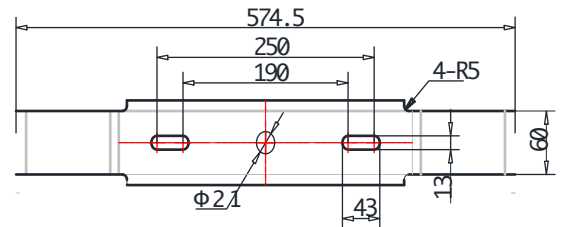
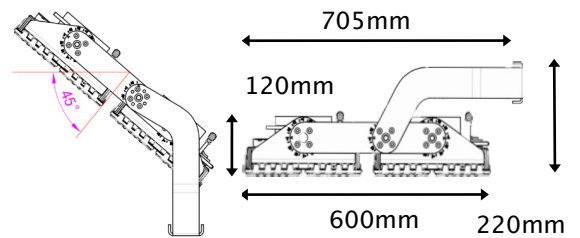

114x17 B/Angle

BMP-STADL1251-1000-150V-10D4

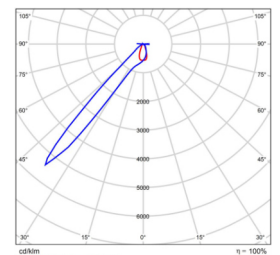

45x12 B/Angle

BMP-STADL2318-1000-150V-10D4

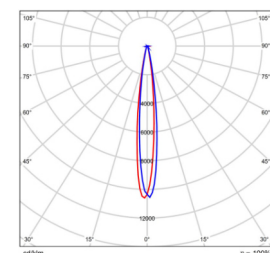

12x12 B/Angle

BMP-STADL12-1000-150V-10D4

*See 5050 series for additional beam angles*



# 1000W MODULE SPORTGROUND DALI SERIES 415V (3 PHASE)

3535 LUXEON SERIES

BMP-STADLV-1000-150V-10D4

For accessories, contact BMP LED via  
[www.bmpled.com.au/contact](http://www.bmpled.com.au/contact)

## ACCESSORIES



Light Shields  
BMP-FL40SHIELD-10



Red Laser pointer  
BMP-REDLPOINT-10



Driver Extension Cable  
2.0m,5.0m,12.0 lengths  
BMP-DEC/2/5/12-10

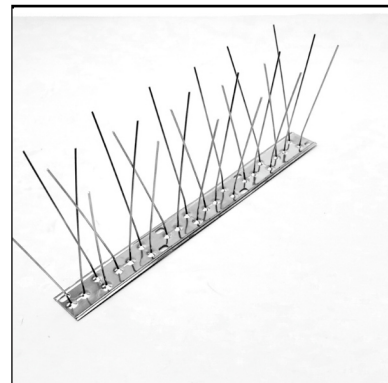

Birdspikes  
0.33m  
BMP-BIRDSPIKES-10