



1000W MODULE SPORTGROUND LIGHT SERIES

5050 LUMILED SERIES

BMP-STADV-1000-150V-10



SPECIFICATIONS	
System Power	1000w
Milliamps	1250Ma
LED type	LUMILED 5050 96Pcs each Module
Lamp Body Material	Powdercoated Galvanised Steel
Colour Temperature	4000k(3000k,5700kopt)
Luminous Flux	155,050 Lumens
Luminous Efficacy	155 Lm/w
CRI	Ra80 (Ra70/90 optional)
Beam Angle	25X25, 40X40, 60X60
Rated Lifespan	>100,000 hours Modules
IP Rating	IP67 Housing , IP68 Modules
Impact rating	IK09
Driver Type	Moso X6-240M229x4pcs Flicker Free
Operating Temperature	-40°C ~ 50°C
Dimmable	PWM Dimming
Test Reports	ISMT,LCP, TM21, LM80, L70
Lamp Dimension	705 x 645 x 220 mm
Net Weight	19.3kg + 4.6kg drivers
Warranty	5 years drivers, 10 years Modules
Certification	JAS/ANZ TUV

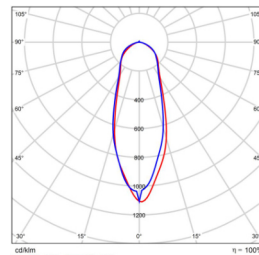
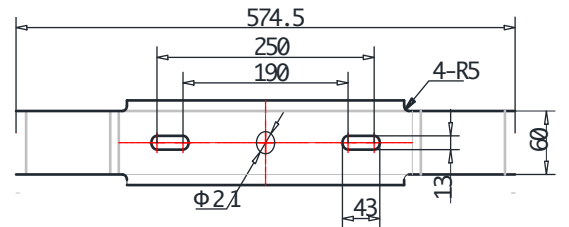
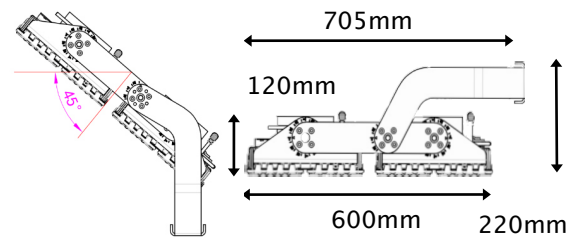

25 X 25 B/Angle
BMP-STAD25-1000-150V-10

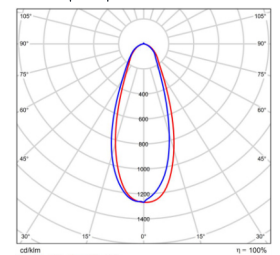

40x40 B/Angle
BMP-STAD40-1000-150V-10

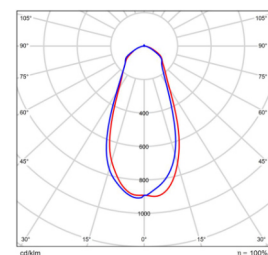

60x60 B/Angle
BMP-STAD60-1000-150V-10

See 3535 series for additional beam angles



1000W MODULE SPORTSGROUND LIGHT SERIES

5050 LUMILED SERIES BMP-FLMODV-1000-150V-10

For accessories, contact BMP LED via
www.bmpled.com.au/contact

ACCESSORIES



Light Shields
BMP-FL40SHIELD-10



Red Laser pointer
BMP-REDLPOINT-10



Driver Extension Cable
2.0m,5.0m,12.0 lengths
BMP-DEC/2/5/12-10

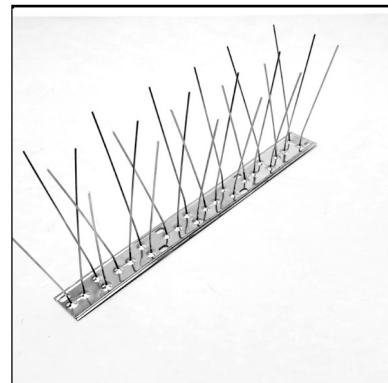

Birdspikes
0.33m
BMP-BIRDSPIKES-10