



LED

40W 1 MODULE 24VDC STREETLIGHT LIGHT SERIES

BMP-STREET24VDC1-40-150V-10

- White
- Grey
- Black



SPECIFICATIONS

System Power	40w
Milliamps	7800Ma 46v
LED type	LUMILEDS 5050 28Pcs each Module
Lamp Body Material	Aluminium Alloy
Colour Temperature	5700k,4000k,3000k
Luminous Flux	7,170lumens
Luminous Efficacy	178lm/w
CRI	Ra70 (Ra80/90 optional)
Beam Angle	TYPE I, II , III , IV , V
Light Distribution Curve	Various
Rated Lifespan	>100,000 hours Modules
IP Rating	IP66 Housing , IP68 Modules
Impact rating	IK08
Driver Type	Flicker Free D5-40-56-A
Operating Temperature	-40°C ~ 50°C
Dimmable	PWM Dimming
Test Reports	TM21,LM80,L70
Lamp Dimension	577 x 330 x 155 mm
Net Weight	7.2kg
Warranty	5 years driver, 10 years Modules
Certification	JAS/ANZ TUV

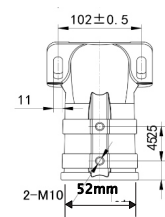
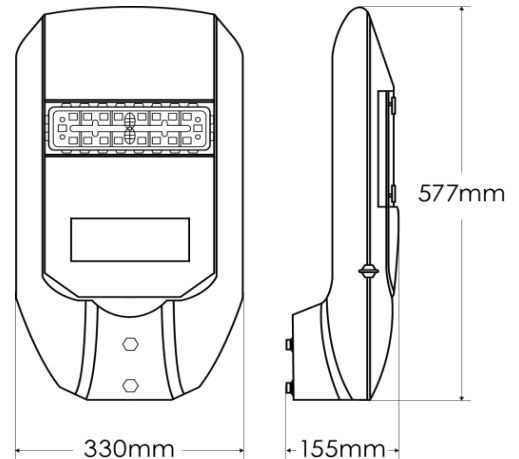

BMP-L40-10

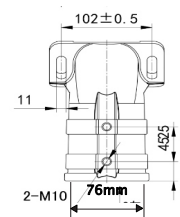

BMP-L70-10

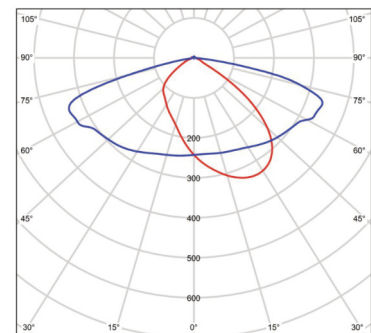

Type II (Most Common)
BMP-STREET24VDC2-40-150V-10

See next page for other distributions



40W 1 MODULE 24VDC STREETLIGHT LIGHT SERIES

BMP-STREET24VDC1-40-150V-10

For accessories, contact BMP LED via www.bmpled.com.au/contact

ACCESSORIES

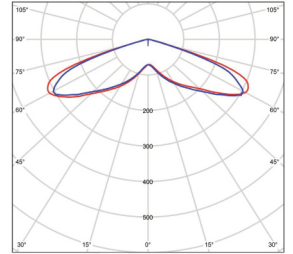
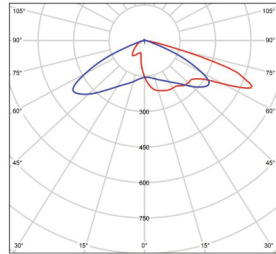
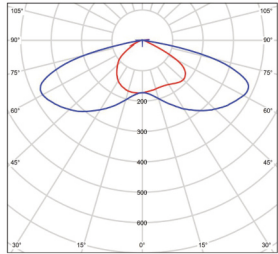
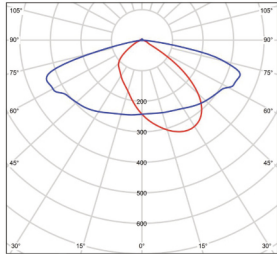
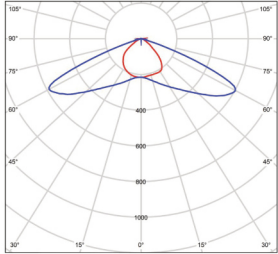

Type I

Type II

Type III

Type IV

Type V

BMP-STREET24VDC1-40-150V-10

BMP-STREET24VDC2-40-150V-10

BMP-STREET24VDC3-40-150V-10

BMP-STREET24VDC4-40-150V-10

BMP-STREET24VDC5-40-150V-10

(Most Common)

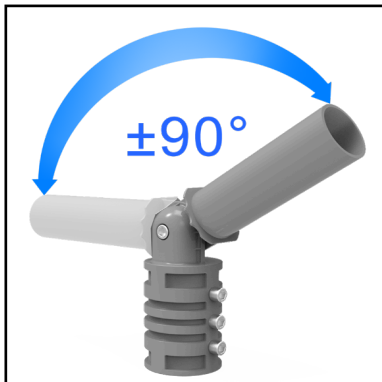

Streetlight pole Adaptor
Black/Grey/White Options
BMP-STREETAD-10(B/G/W)



3 Pin Phot Cell
Pe Cell and base
BMP-STREETCELL3-10



Driver Extension Cable
2.0m,5.0m,12.0 lengths
BMP-DEC/2/5/12-10

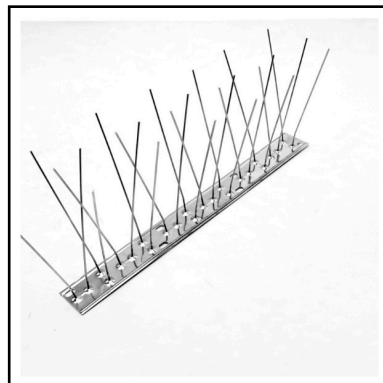

Birdspikes
0.33m
BMP-BIRDSPIKES-10